

Village of Morton Zoning & Code Enforcement Department

120 N. Main St., Morton, IL 61550

Phone: (309)266-5361 Fax: (309)266-5508 Email: bmarks@morton-il.gov

DRIVEWAY ADDITION AND/OR REPLACEMENT PERMIT FORM

(Use this form if you are adding onto or replacing a driveway, driveway approach, or curb)

PROPERTY OWNER: _____	Email: _____
Address: _____	Phone: _____

GENERAL CONTRACTOR: _____	Email: _____
IF APPLICABLE - IF OWNER MARK "SELF"	
Address: _____	Phone: _____

CONCRETE CONTRACTOR: _____	Email: _____
IF APPLICABLE	
Address: _____	Phone: _____

SITE & PROJECT INFORMATION

NOTE: Meeting the correct setbacks from the property line is the responsibility of the owner/applicant

Please see the attached Appendix for setback and driveway width guidelines

Site Address _____

Setback from Side Property Lines _____ & _____

Driveway Dimensions _____

Project Cost: \$ _____

Please indicate which of the following you plan to replace and/or expand:

- Driveway
- Approach
- Curb

Village of Morton Zoning & Code Enforcement Department

120 N. Main St., Morton, IL 61550

Phone: (309)266-5361 Fax: (309)266-5508 Email: bmarks@morton-il.gov

Please provide a basic drawing, with dimensions, showing the location of the drive and the proposed changes. Please use the attached appendix for guidance.

PROJECT DRAWING:

It is hereby certified that the above use as shown on the plats and plans submitted with the application conforms with all applicable provisions of the Village of Morton Zoning Ordinance. The issuance of this Permit does not allow the violation of Village of Morton Zoning Ordinances or other governing Regulations.

Any changes or alteration in the accompanying submittal subsequent to the issuance of this permit without approval from the Zoning and Code Enforcement Officer shall constitute sufficient grounds for revocation of such permit.

Applicant understands and agrees with the terms of the permit.

Printed Name of Applicant: _____

Signature of Applicant: _____

Date: _____

Signed by the:

Contractor

Agent

Owner

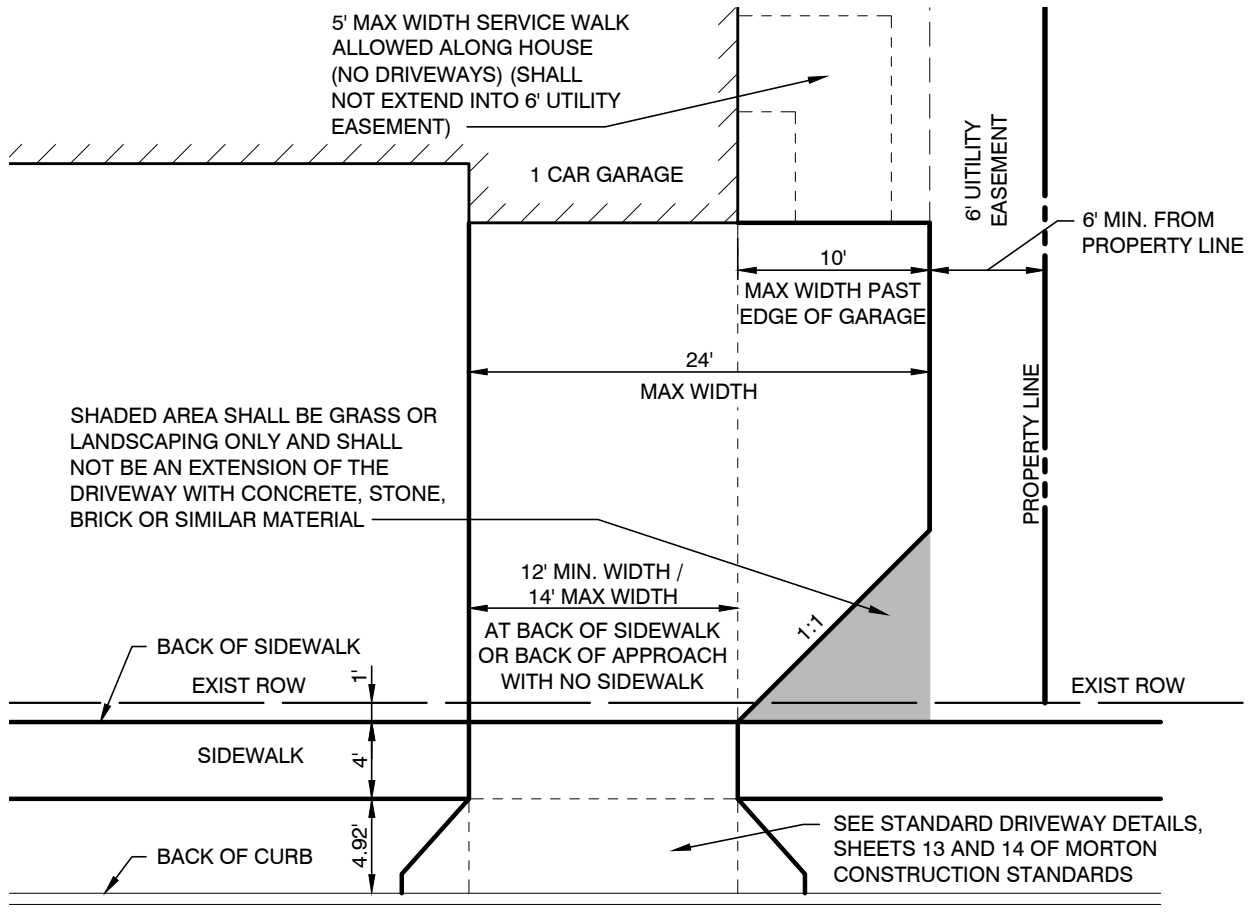

1 CAR GARAGE

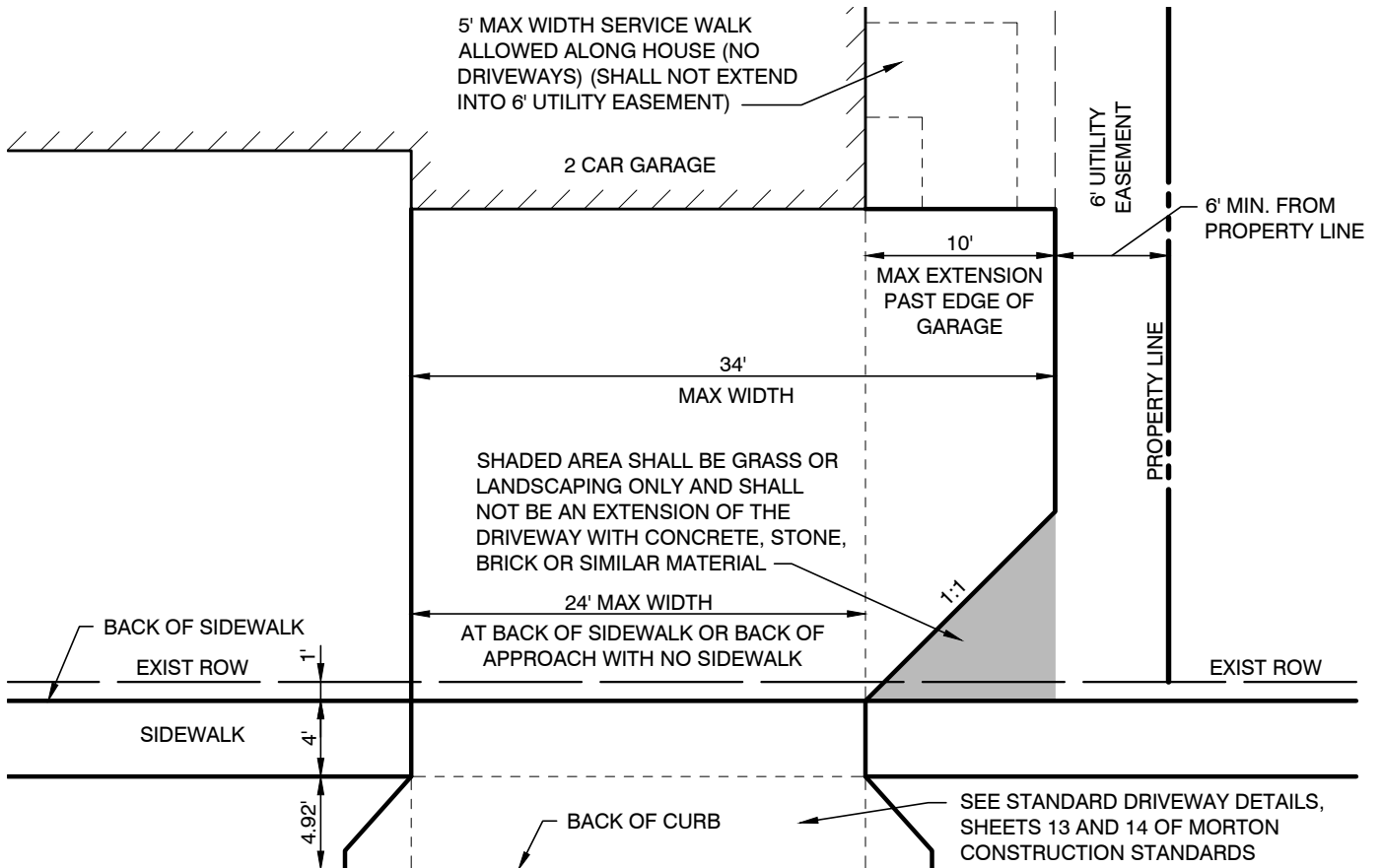

2 CAR GARAGE

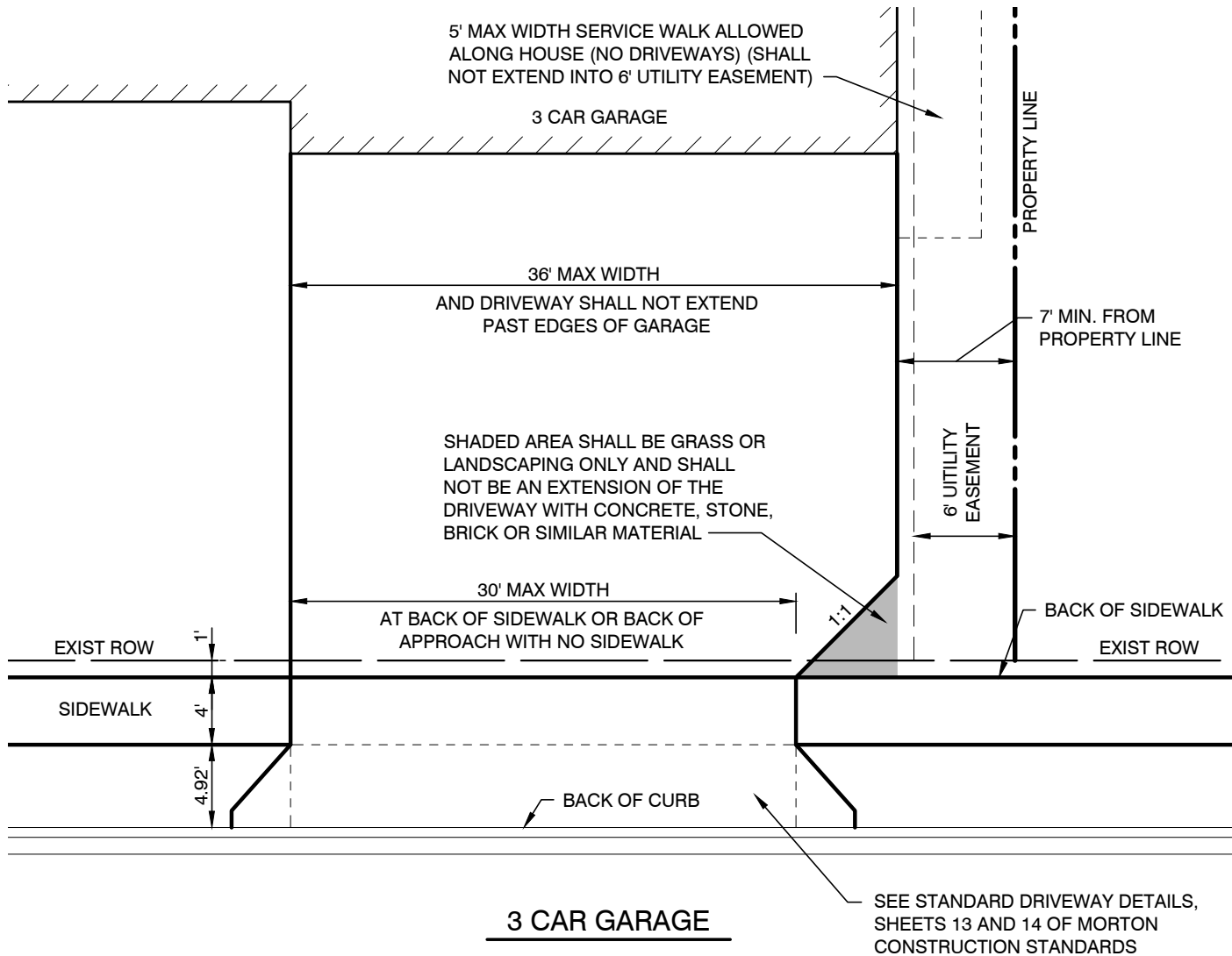

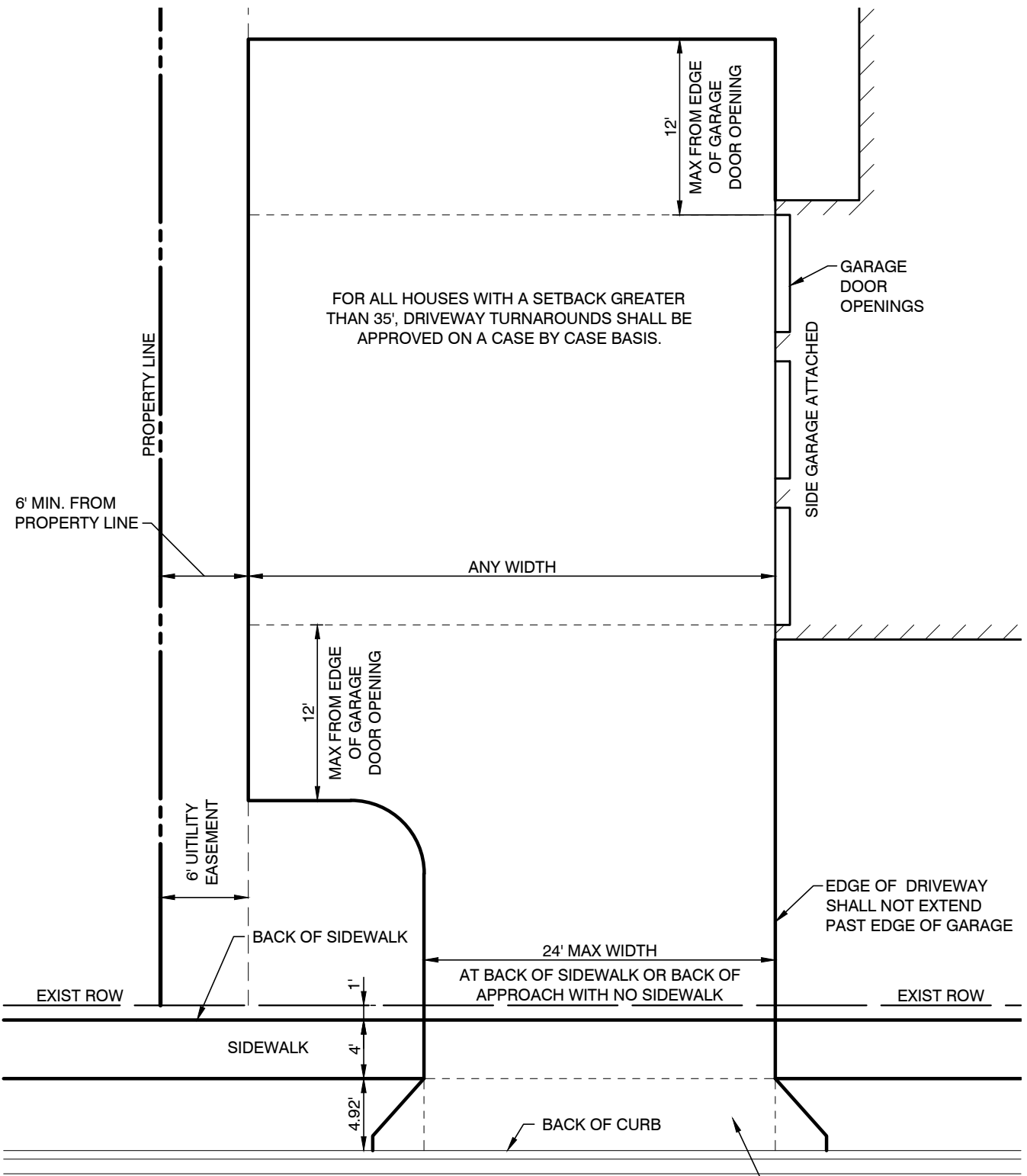

FOR ALL HOUSES WITH A SETBACK GREATER THAN 35', DRIVEWAY TURNAROUNDS SHALL BE APPROVED ON A CASE BY CASE BASIS.

SIDE GARAGE ATTACHED

SEE STANDARD DRIVEWAY DETAILS, SHEETS 13 AND 14 OF MORTON CONSTRUCTION STANDARDS